

- 1. Metal stud
- 2. Substrate
- 3. Moisture barrier
- 4. Mineral wool type insulation (thickness per spec.)
- 5. Aluminum horizontal Z-girts (or double L angles)
- 6. ALPHATON® terra cotta panel
- 7. Vertical support aluminum extrusion
- 8. Terra cotta middle panel aluminum clip
- 8.1 Terra cotta top panel aluminum clip
- 9. Double backer rod & sealant
- 10. Blocking
- 11. Formed aluminum sill
- 11.1. Alternative aluminum extruded sill
- 12. Formed aluminum non-cont. support clip
- 13. Pressure gasket
- 14. Stainless steel spring clip

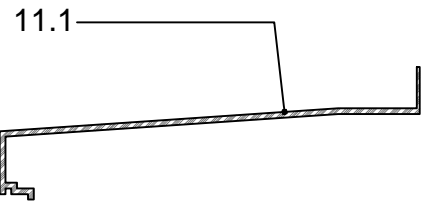

Version-4.0

SYSTEM:	DETAIL No.	OPTION.
ALPHATON	M212	a

METAL SILL DETAIL

Note: This is conceptual detail; project specific details must be reviewed with Shildan



Shildan, Inc.
 2047 Briggs Road
 Mount Laurel, NJ 08054
 T: (215) 525-4510
 F: (215) 525-4511
 ©2008 by Shildan, Inc.

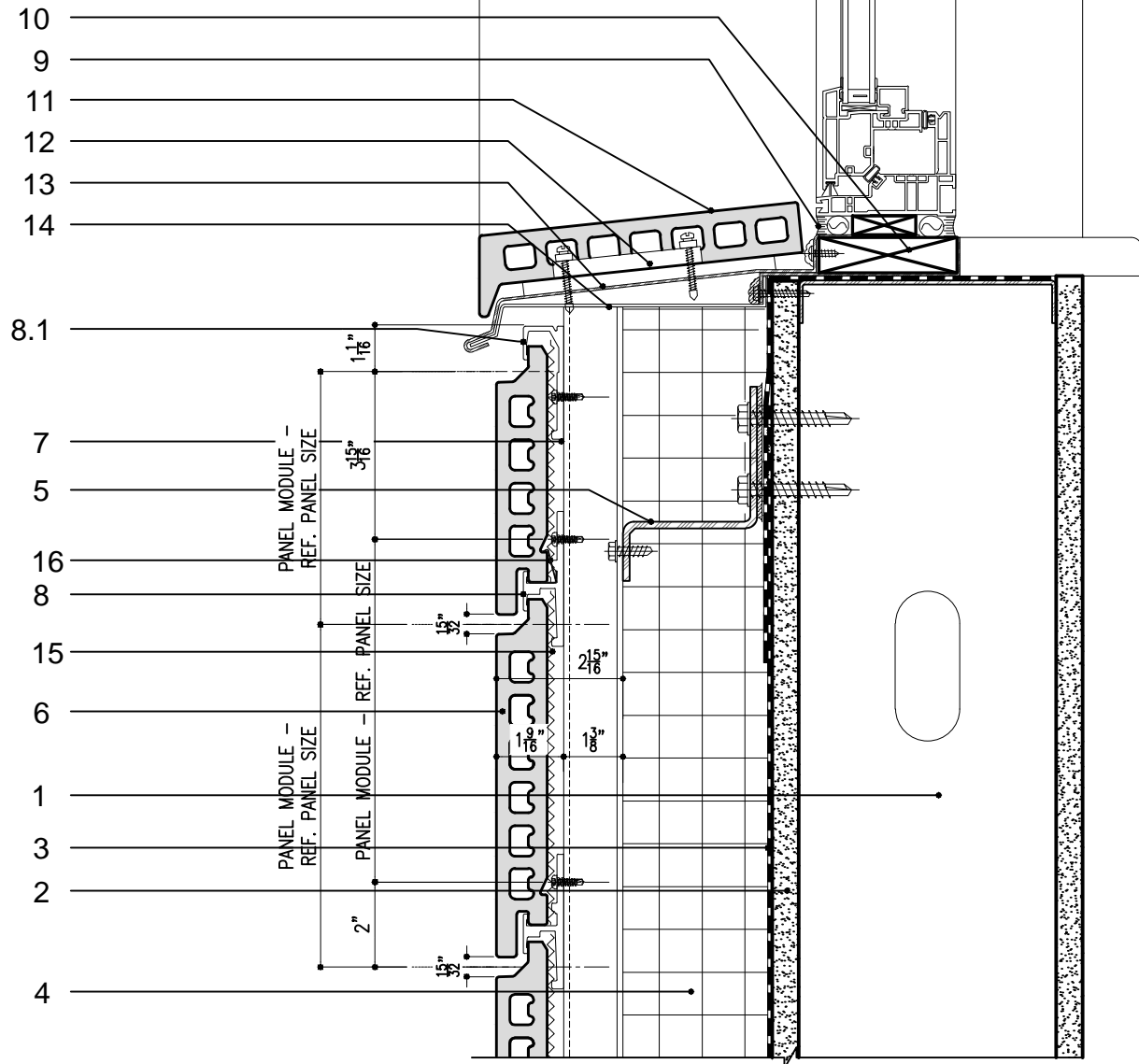

- | | |
|---|--|
| <ul style="list-style-type: none"> 1. Metal stud 2. Substrate 3. Moisture barrier 4. Mineral wool type insulation (thickness per spec.) 5. Aluminum horizontal Z-girts (or double L angles) 6. ALPHATON® terra cotta panel 7. Vertical support aluminum extrusion 8. Terra cotta panel middle aluminum clip 8.1 Terra cotta panel top aluminum clip 9. Sealant & backer rod | <ul style="list-style-type: none"> 10. Blocking 11. Terra cotta sill 12. Pressure attachment clip 13. Formed aluminum flashing sill 14. Formed aluminum clips (non-cont.) 15. Pressure gasket 16. Stainless steel spring clip |
|---|--|

Version-4.0

SYSTEM: ALPHATON	DETAIL No.	OPTION.
M2	12	b

TERRA COTTA SILL DETAIL

Note: This is conceptual detail; project specific details must be reviewed with Shildan



Shildan, Inc.
 2047 Briggs Road
 Mount Laurel, NJ 08054
 T: (215) 525-4510
 F: (215) 525-4511
 ©2008 by Shildan, Inc.