

- | | |
|---|--|
| 1. Metal Studs wall cavity | 8. Balcony structure |
| 2. Substrate | 9. Soffit panel (per arch specs.) |
| 3. Waterproofing membrane | 10. Mineral wool type insulation (thickness per spec.) |
| 4. Horizontal substructure aluminum extrusion | 11. Backer rod and sealant |
| 5. Terra cotta fastening middle aluminum clip | 12. Formed aluminum closure |
| 5.1 Terra cotta fastening top aluminum clip | 13. Formed aluminum clip (as req.) |
| 6. ALPHATON GEN.06-150 ® terra cotta panel | 14. Panels beyond |
| 7. Not used | |

Version-8

SYSTEM:
ALPHATON

DETAIL No.

OPTION.

Gen. 06 16 a

**TERMINATION DETAIL
@ SOFFIT (FULL PANEL)**

Note: This is conceptual detail; project specific details must be reviewed with Shildan



Shildan, Inc.

2047 Briggs Road
Mount Laurel, NJ 08054
T: (215) 525-4510
F: (215) 525-4511

©2008 by Shildan, Inc.

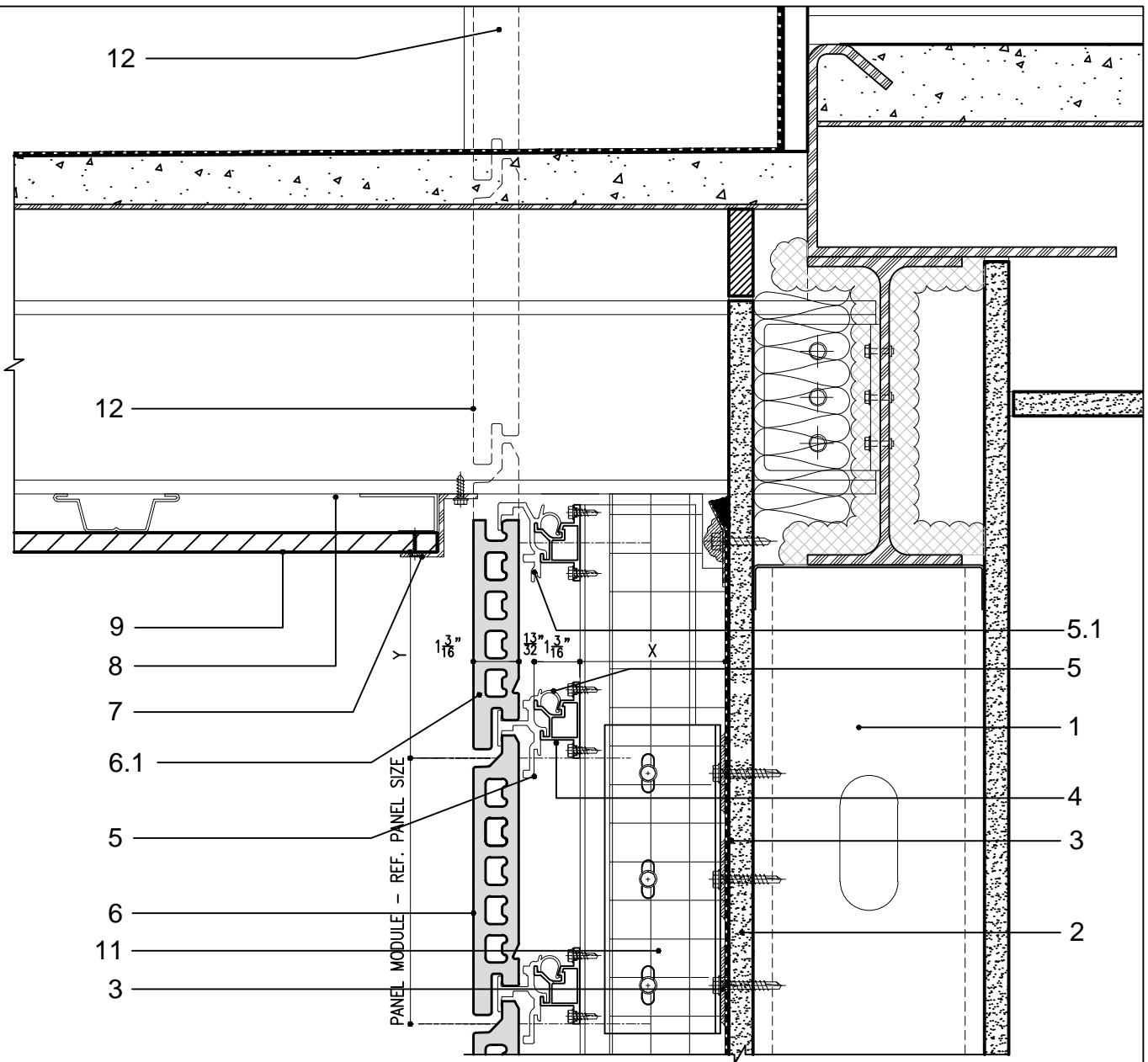

- | | | | |
|-----|---|-----|--|
| 1. | Metal Studs wall cavity | 7. | Formed aluminum soffit termination z-clip |
| 2. | Substrate | 8. | Balcony structure |
| 3. | Waterproofing membrane | 9. | Soffit panel (per arch specs.) |
| 4. | Horizontal substructure aluminum extrusion | 10. | Not used |
| 5. | Terra cotta fastening middle aluminum clip | 11. | Mineral wool type insulation (thickness per spec.) |
| 5.1 | Terra cotta fastening top aluminum clip | 12. | Panels beyond |
| 6. | ALPHATON GEN.06-150 ® terra cotta panel | | |
| 6.1 | ALPHATON GEN.06-150 ® terra cotta panel cut to size | | |

Version-8

SYSTEM:
ALPHATON

DETAIL No.

OPTION.

Gen. 0616 b

**TERMINATION DETAIL
@ SOFFIT (CUT PANEL)**

Note: This is conceptual detail; project specific details must be reviewed with Shildan



Shildan, Inc.

2047 Briggs Road
Mount Laurel, NJ 08054
T: (215) 525-4510
F: (215) 525-4511

©2008 by Shildan, Inc.